

140
141

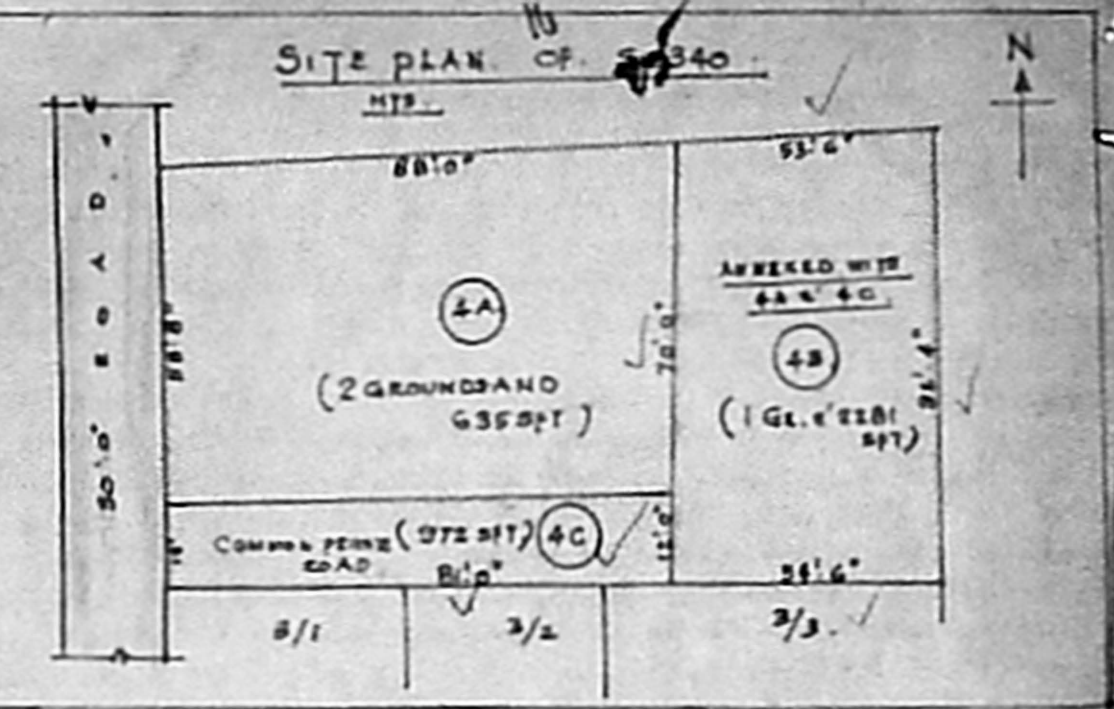

NOTE: DOCUMENT REFERENCE: SITE PLAN

4A	AREA	5435 SFT	(2 GRS 6350 FT)
4B	AREA	4681 SFT	(1 GR. 2281 SFT)
4C	AREA	4681 SFT	(1 GR. 2281 SFT)
4D	AREA	4681 SFT	(1 GR. 2281 SFT)
TOTAL		19483 SFT	(4 GRS 14885 FT)

108.5 x 110.8 SFT

AREA DETAILS (SUBDIVISION)	
PLOT MKD. (A)	: 1981 SFT.
" " (B)	: 2265 SFT.
" " (C)	: 2498 SFT.
" " (D)	: 3136 SFT.
COMMON PRIVATE ROAD (E)	: 1212 SFT.
TOTAL: 11088 SFT. OR 4 GROUND 14885 FT.	

PROPOSED SUB DIVISIONS OF
PLOT NO: 4, I CROSS STREET,
BHARATHI NAGAR, ZAMIN PALLAVARAM
MADRAS. 600043 (S.NO. 340)

SCALE: 8" = 1" DEPT: G.P.D.
DRG NO: SA/F/012/92. CDD:
SRI VISWU ASSOCIATES
ARCHITECTS & ENGINEERS
MADRAS. 600005.

S. ANANTHACHARI, F.I.R.A., M.
Registered Architect & Engineer No. C.A. 21
Class-I Licensed Surveyor No. R.A. 23
CORPORATION OF MADRAS
44, CAR STREET,
TRIPLIKANE, MADRAS, 600 005
LICENCE NO. 14885/92

OWNER:
Anelva Shivaji

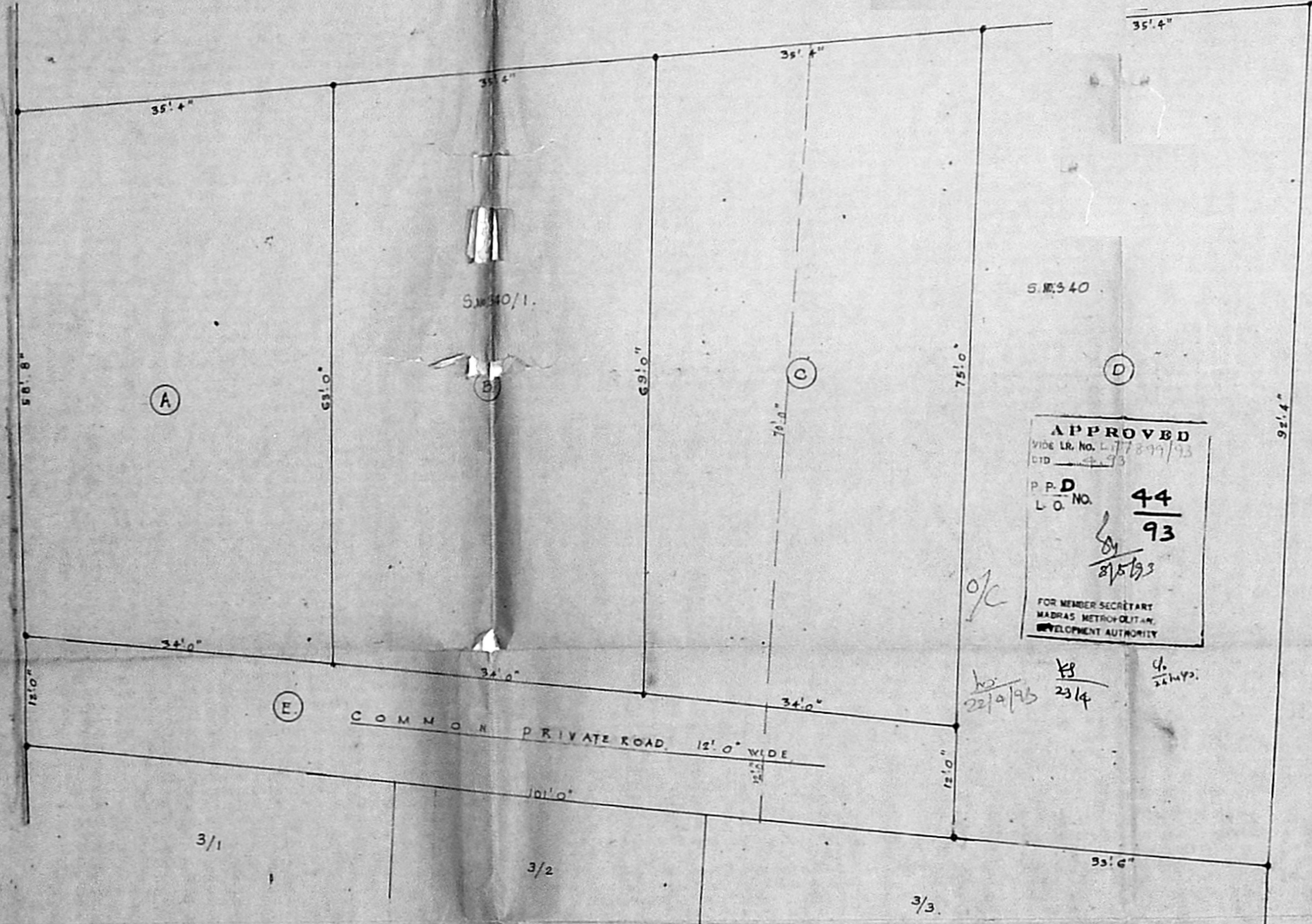

APPROVED
VIDE LR. NO. L/7899/93
D/D 4/93
P.P.D. NO. 44
L.O. NO. 93
8/5/93
FOR MEMBER SECRETARY
MADRAS METROPOLITAN
DEVELOPMENT AUTHORITY

10/22/95
18/23/94
16/24/95

(E) COMMON PRIVATE ROAD, 12' 0" WIDE

3/1

3/2

3/3